

Operating instructions Solar lights „Fritzi“



Customer support:

If you have problems or questions regarding this product, simply contact us!

Internet: www.esotec.de

By phone: +49 9605-92206-0

By e-mail for ordering spare parts: ersatzteil@esotec.de

By e-mail for questions about the product: technik@esotec.de

Product: Manufacturer Item No.: 102229

These instructions relate **ONLY** to this product and contain important information for using the product for the first time. Please keep these instructions for later reference and should always accompany the product in the event of transference to a new user.

1. Introduction

Dear Customer,

Thank you for purchasing the solar light.

With this solar light you purchased a product manufactured according to the current state of technology.



This product fulfils all requirements of the valid European and national regulations. The conformity was proved. The relevant declarations and documentation are deposited with the manufacturer.

manufacturer.

To maintain this state and guarantee a safe operation, you as the user will have to follow this operating manual! This product is designed for private use only.

2. Safety Instructions



- In case of damages caused by not following this operating manual, the warranty rights will expire! We exclude liability for any consequential damages!
- We exclude liability for property or personal damages caused by inappropriate handling or not following the safety instructions.
- In these cases any guarantee rights will expire.

Due to safety and admission reasons (CE) it is not allowed to arbitrarily reconstruct and/or change the solar light.

Therefore, please keep to the operating manual.

3. Intended Use and Function

The solar lights are designed for outdoor use. They can be placed in the ground with an earth spike. Make sure that the solar lights are firmly fixed in the ground with the earth spike and provide sufficient support. When choosing the place of installation, please pay attention to a shadow-free sunny place. The lights must not stand in the water and must not constitute tripping hazards. During the winter months, the solar lights have to be switched off and stored charged in a frost-free place inside.

The integrated rechargeable battery is charged by the solar cell inside the light. The light is automatically switched on at darkness and switched out at morning light. An energy-saving light emitting diode (LED) is used as illuminant.

During longer periods with insufficient insolation, the accumulator is charged insufficiently in order to ensure a permanent readiness for operation. **However, that does not mean that the solar light is defective.** Please wait for the next sunny days and the light will work accordingly or charge the accumulator with a standard charger.

4. Putting into Operation

1. Carefully remove the solar light from the packaging.
2. Carefully turn the candle clockwise out of the metal holder and remove it (Picture 1).
3. Push the switch on the bottom of the candle to the ("ON") position to switch it on (Picture 2).
4. Replace the candle into the metal holder and tighten it counterclockwise (Picture 3).
5. Screw the two parts of the ground spike together in the middle (Picture 4) and insert it into the ground.
6. Screw the metal holder with the solar spit then on the earth spike (Picture 5).

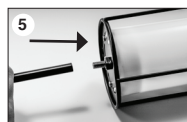
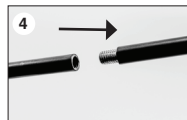

The solar lights are now activated and ready for use!
Note:

The duration of illumination is strongly dependent on the intensity and duration of sunshine during the day. On days with insufficient sun, the duration of illumination will generally be shorter. In case the light should not give light on the first evening, please wait for a sunny day or charge the batteries in a commercially available battery charger.

5. Exchange of the Battery

For solar lights, it is required to exchange the battery every 2 years on average. Please only insert an identical in construction battery with identical voltage and identical capacity. In case you should not get this capacity in a store you are also able to use batteries with a higher capacity.



1. Turn the candle clockwise out of the metal holder and remove it (Picture 6)
2. Push the switch on the bottom side to the "OFF" position (Picture 7).
3. Unscrew the 6 screws on the battery compartment on the underside of the solar lamp with a suitable screwdriver (Picture 8).
4. Remove the plastic seal and the cover (Picture 9)
5. Remove the battery from the holder and replace it with a new freshly charged battery of the same size (Picture 10).
6. Put the seal back into the battery compartment and close the cover again.
7. Push the switch in the reverse direction on the bottom back to the "ON" position and reattach the candle to the metal frame and ground stake.

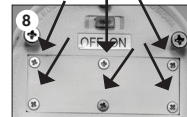

Note: used batteries must be disposed of in an environmentally friendly manner and should not be placed in your household waste. Your dealer is obliged by law to take back the old rechargeable batteries.

6. Malfunctions

Lamp is not automatically switched on at darkness

- An outside light source (e.g. streetlight) simulates daylight and prevents the lamp from switching on? Place the lamp at a darker location!

Lamp is not switched on at darkness or only for a short period of time.

- Is the lamp connected?
- Accumulator weak or defective? Exchange of the accumulators.

7. Technical Data

Solar module crystalline :	2 V/100 mA
Illuminant:	1 yellow-orange flickering light
lightBattery NiMh:	1,2V/300mAh (Micro/AAA)
Protection class:	IP 44
Type of protection:	III
Max. glow time:	6h with full charged bater

Battery Recycling:

- Used batteries or accumulators must be disposed in the domestic waste.
- The consumer is legally obliged to bring back old accumulators upon usage, e.g. to public waste collecting locations or to the place (shops, etc.) where those batteries are sold.
- Batteries that contain harmful substances are marked with the "strike through dustbin" and one of the chemical symbols.

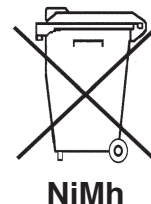

Rechargeable battery notes

- Rechargeable batteries should not be played with by children. Never leave rechargeable batteries lying around; they could be swallowed by children or pets.
- Rechargeable batteries must never be short-circuited, disassembled or thrown into fire. This leads to a danger of explosion!
- Leaking or damaged rechargeable batteries can cause chemical burns when they come into contact with skin. For this reason, please make use of suitable protective gloves.
- Rechargeable batteries should only be replaced by structurally identical rechargeable batteries from the same manufacturer. Normal batteries must not be used since these are not rechargeable.
- Make sure the rechargeable batteries are inserted with the correct polarity.
- For long periods of time of non-use (for example, storage), remove the inserted rechargeable batteries to avoid damages via the leaking rechargeable batteries.

Manufacturer/Importer:

esotec GmbH - Gewerbegebiet Weberschlag 9 - D-92729 Weiherhammer
Tel.-Nr: +49 9605-92206-0 - Fax.-Nr: +49 9605-92206-10 - Internet: www.esotec.de

Disposal:

Dear customer,
please cooperate in avoiding waste. When you intend to dispose of the product in future, please consider that it contains valuable raw materials suited for recycling.
Therefore, do not dispose it of with domestic waste but bring it to a collection point for the recycling of waste electrical and electronic equipment.

Thank you very much for your cooperation!

